

FOLD UP SEAT CONVERSION PACKAGE OP169

- 1 To install seat at future date, remove nylon bolts (fig.1).
- 2 Open seat frame and locate (6) s.s. bolts.
- 3 Before securing frame, place a bead of caulk around both support flanges (fig.2).
- 4 Position seat frame in shower & secure with s.s. bolts. Clean off excess caulk (fig. 3).
- 5 Seat may be removed. Retain nylon bolts in stock for future use.

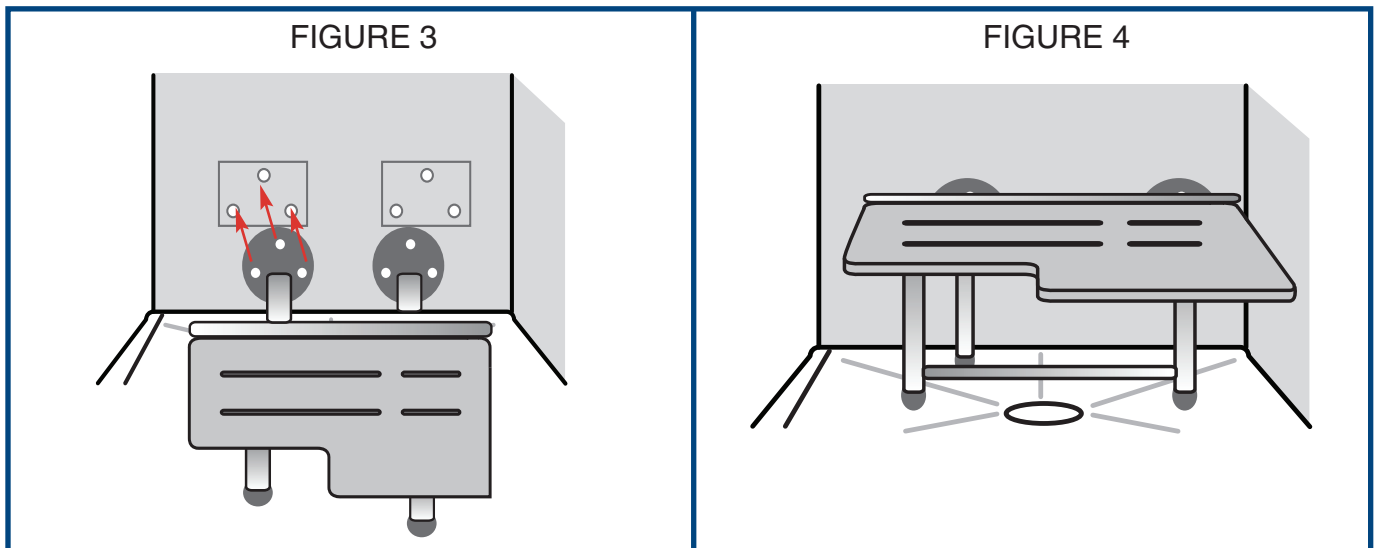
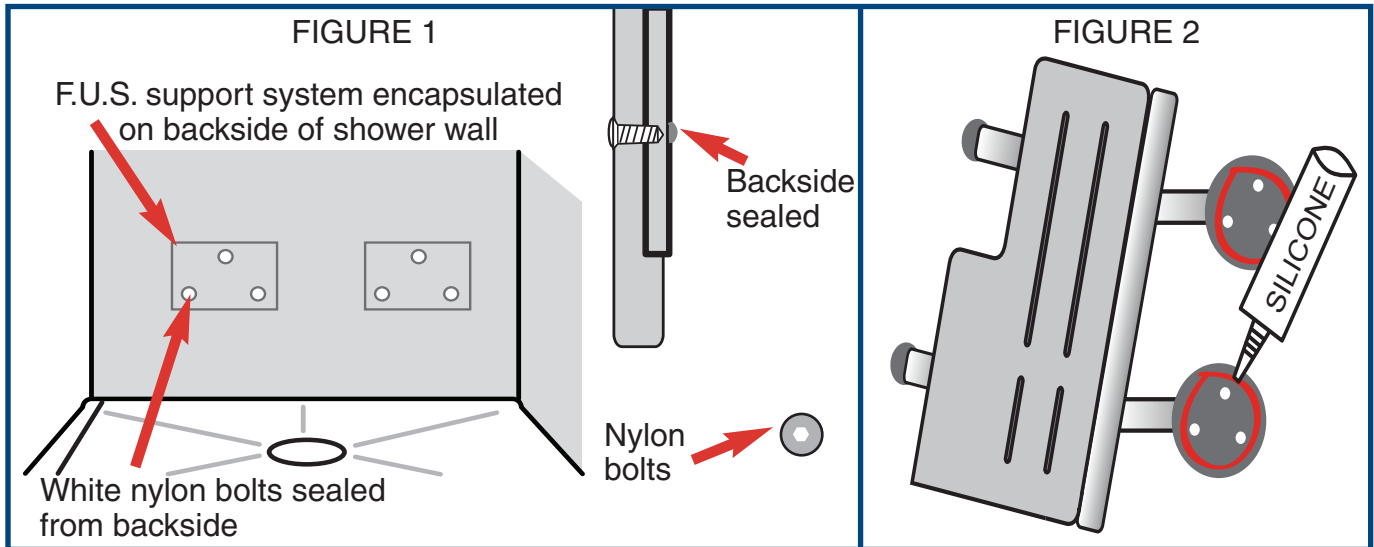

CUSTOMER SERVICE & TECHNICAL SUPPORT

Tel: 800-567-0920
Fax: 800-935-5785
Email: service@acryline.ca
Web: acryline.ca